

# Farnborough Growth Package Improvements

## 1. Welcome

**Hampshire County Council is developing a scheme for transport improvements in the Farnborough area**

This exhibition aims to:

Provide information on the existing issues

Seek local views to inform the design process

Present some initial highway improvement options

Outline the next steps for the scheme

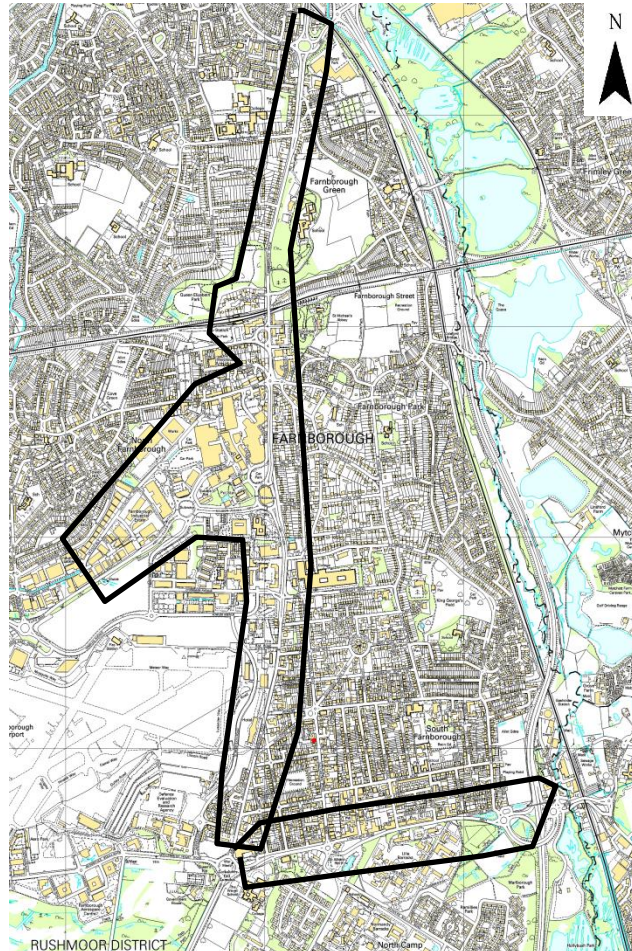

This consultation is an opportunity for local residents and businesses to provide their views on the existing issues, the scope of possible improvements in the Farnborough Area.

The study area (illustrated on the adjacent map) is focussed on the A3011 Lynchford Road, A325 Farnborough Road and Town Centre

**Please take a look at the exhibition boards, ask questions and complete a questionnaire.**

© Crown copyright and database rights 2017 Ordnance Survey [100019180]. Use of this data is subject to terms and conditions. You are granted a non-exclusive, royalty free, revocable licence solely to view the Licensed Data for non-commercial purposes for the period during which HCC makes it available. You are not permitted to copy, sub-license, distribute, sell or otherwise make available the Licensed Data to third parties in any form. Third party rights to enforce the terms of this licence shall be reserved to Ordnance Survey



# Farnborough Growth Package Improvements

## 2. Background and Introduction

### What is the Farnborough Growth package?

- Range of transport improvements that aim to support economic growth in Farnborough and the surrounding area by reducing congestion, improving journey times and increasing travel choice. Funding is primarily being provided by the Enterprise M3 Local Enterprise Partnership (EM3 LEP) through its Growth Deal with Central Government, matched by local contributions.

### What is the Blackwater Valley Gold Grid?

- Investment in sustainable transport measures across the whole Blackwater Valley area, primarily funded by the EM3 LEP. Within Farnborough, this will fund improvements to support the Stagecoach Gold Route 1 service, matched by investment made by Stagecoach in new buses.

### About the consultation

- We want to hear your views on suggested improvements, including alternative options in some locations;
- Feasibility work commissioned by the County Council considered a wide range of improvements that could be implemented;
- As there is insufficient funding currently available to implement the whole Package, the consultation is also seeking views on the options that have been identified for implementation in the short term;
- All further design work on suggested options will fully consider the needs of all road users; and
- All suggested improvements are only suggestions at this stage.





# Farnborough Growth Package Improvements

## 3. Suggested Options – A3011 Lynchford Rd (Queen’s Roundabout to St Alban’s Roundabout)

**PEDESTRIAN / CYCLE CROSSING OUTSIDE WAVELL SCHOOL**

**OPTION 1 –** Widen road on nearside in both directions to allow for two traffic lanes

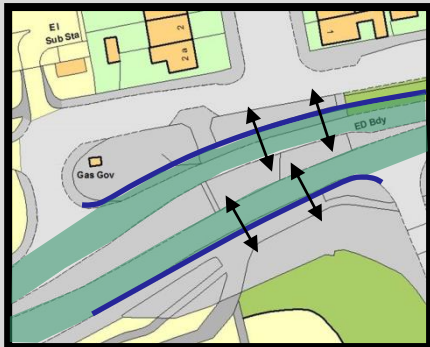

**OPTION 2 –** Widen road in one direction only (westbound shown)

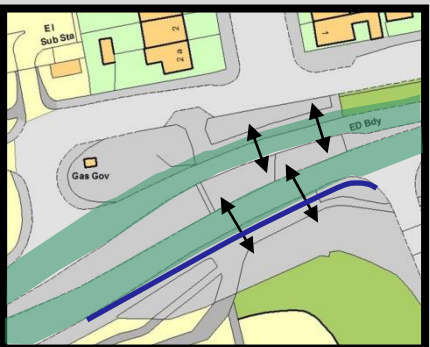

**OPTION 3 –** Do Nothing

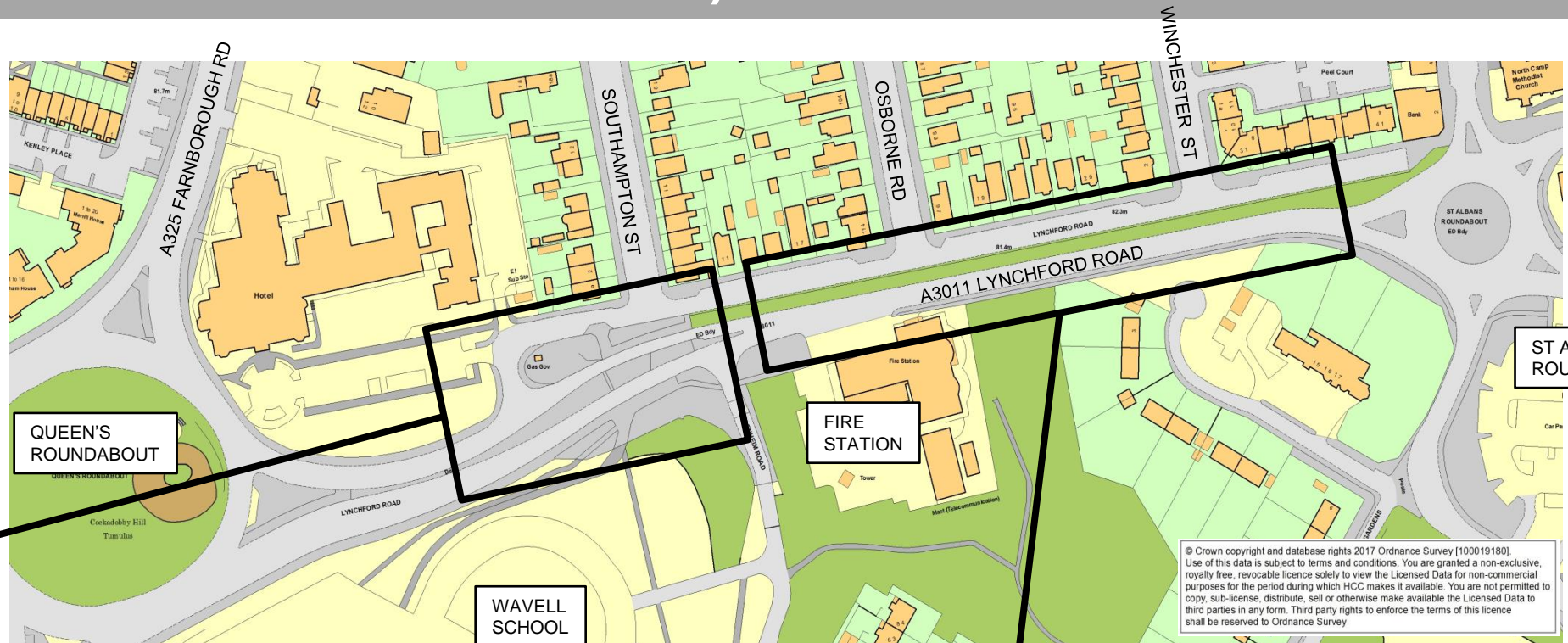
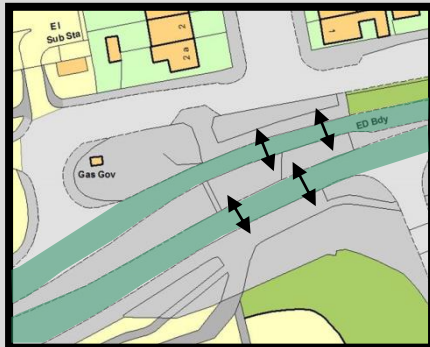

**WAVELL SCHOOL TO ST ALBAN'S ROUNDABOUT**

**OPTION 1 –** Widen road to allow for three marked lanes / two wide lanes

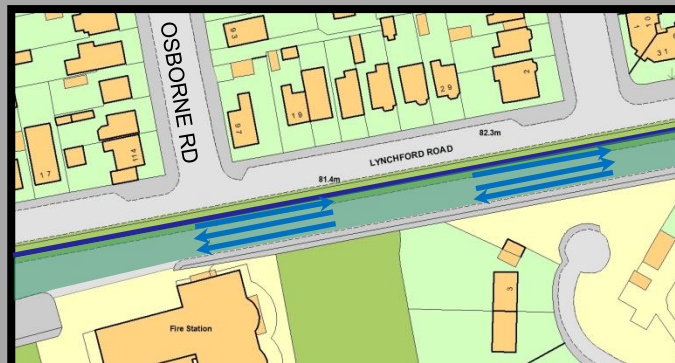

**OPTION 2 –** Widen road to allow for four marked lanes

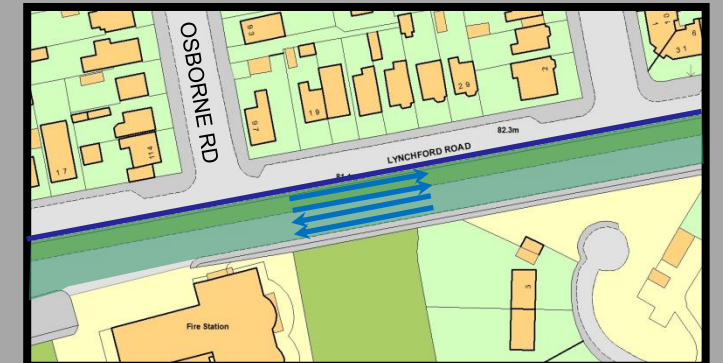

# Farnborough Growth Package Improvements

## 4. Suggested Options – A3011 Lynchford Rd (Queen’s Roundabout to St Alban’s Roundabout)

### PEDESTRIAN / CYCLE CROSSING OUTSIDE WAVELL SCHOOL

#### OPTION 1 – Widen road on nearside in both directions to allow for two traffic lanes

- Would provide two narrow traffic lanes in each direction to increase traffic capacity through crossing in both directions; and
- Operation of crossing would remain as existing.

#### OPTION 2 – Widen road in one direction only (westbound shown)

- Would only widen road in one direction to two lanes, to tie in with three lane option east to St Alban’s Roundabout.

#### OPTION 3 – Do Nothing

- Crossing design and operation would remain unaltered.

### WAVELL SCHOOL CROSSING TO ST ALBAN’S ROUNDABOUT

#### OPTION 1 – Widen road to allow for three marked lanes / two wide lanes

- Would widen existing A3011 road into verge next to Old Lynchford Road;
- Would not affect layout and operation of Old Lynchford Road; although width of dividing landscaping strip reduced; and
- Option to provide three marked lanes, with options for which direction has two lanes **or** mark as two wide lanes with traffic queuing two abreast informally during busy periods.

#### OPTION 2 – Widen road to allow for four marked traffic lanes (two eastbound / two westbound)

- Would provide more traffic capacity than Option 1;
- Would widen existing A3011 road into entire verge next to Old Lynchford Road; and
- Would require narrowing of Old Lynchford Road and likely to result in significant reduction on street parking;



# Farnborough Growth Package Improvements

## 5. Suggested Options – A3011 Lynchford Road (St Alban’s Roundabout to Peabody Road)

**OPTION 1 – Elongated Roundabout (Indicative Layout) and widen A3011**

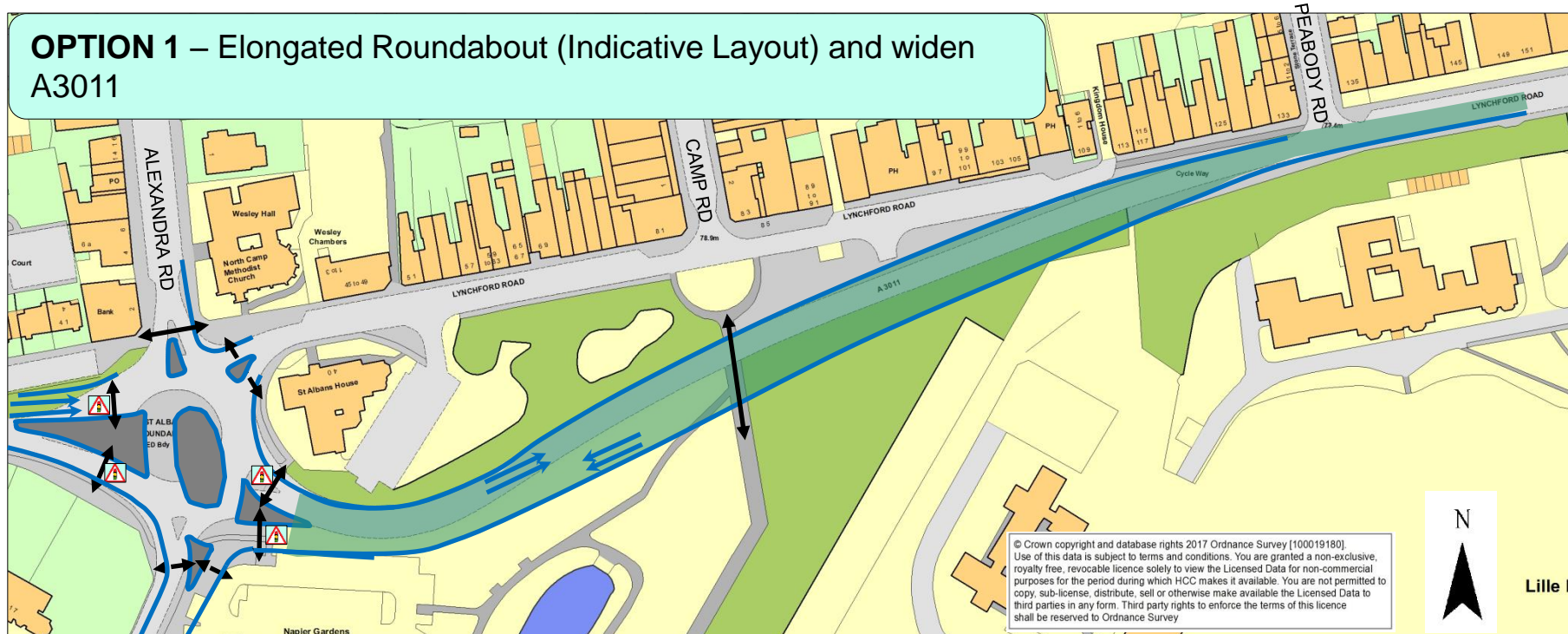

**OPTIONS 1 AND 2 BOTH PROVIDE:**

- Two lanes for through traffic on A3011 at St Alban’s Roundabout, with potential for traffic signal control;
- Potential for two lane entries on Alexandra Road and Queen's Avenue arms;
- Potential for signal controlled pedestrian / cycle crossings over A3011 and Alexandra Road; and
- New footway on west side of Queens Avenue south of St Alban’s Roundabout.

**OPTION 2 – Use Old Lynchford Road for eastbound traffic**

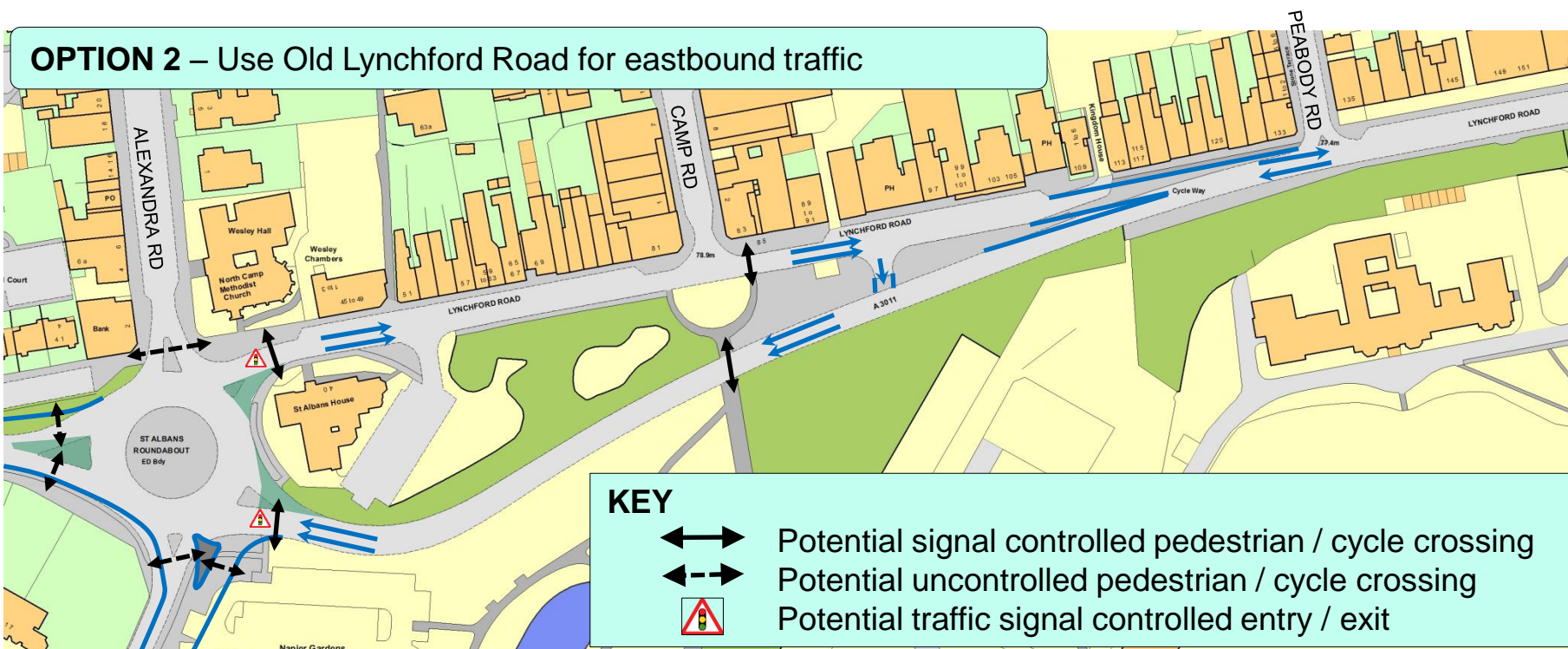

**OTHER FACTORS TO NOTE**

- Option 2 would be cheaper to build than Option 1;
- Option 1 would require more third party land to widen the A3011 and enlarge St Alban’s Roundabout; and
- Option 2 would significantly increase traffic volumes in Old Lynchford Road, although it should be possible to retain existing on street parking. Need to provide alternative safe east to west cycling route.



# Farnborough Growth Package Improvements

## 6. Suggested Options – A3011 Lynchford Road (Peabody Road to A331)

### Preferred Scheme for adoption in Farnborough Growth Package



### PREFERRED SCHEME

- Probably not deliverable in full due to requirement to secure land from the Ministry of Defence in a sensitive area in front of Lille Barracks;
- May only be deliverable in part; and
- Need to consider priorities for implementation.



### Proposed short term proposals

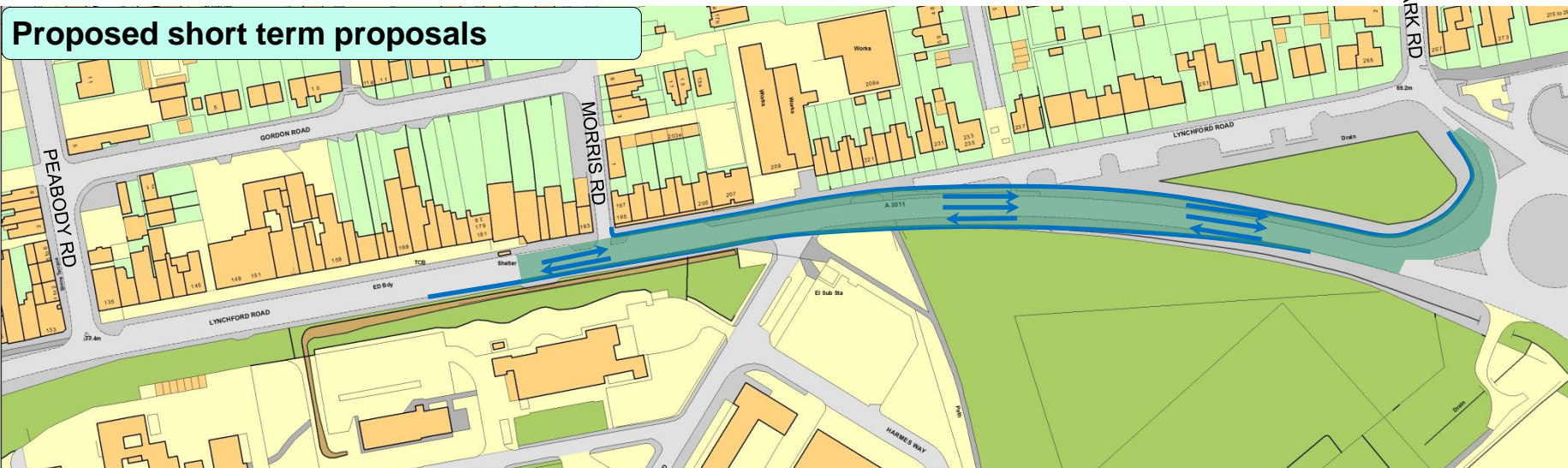

### SHORT TERM PROPOSALS

- Limited widening east of shops to allow two running lanes eastbound to junction with A331; and
- Minimises land take requirements on MoD in short term and should be deliverable.

# Farnborough Growth Package Improvements

## 7. Suggested Options—A325 Farnborough Rd (Bradford's Roundabout to Ham & Blackbird)



### BRADFORD'S ROUNDABOUT

- Widen eastern entry to provide two lane entry to roundabout.

### BRADFORD'S ROUNDABOUT TO EMPRESS AVENUE

- Undertake modelling work to review overall allocation of highway space to maximise throughput of people by all modes.

### BLACKWATER VALLEY GOLD GRID

- Provide enhanced bus stop facilities along Stagecoach Gold Route 1;
- Enhance bus priority through technology and / or infrastructure; and
- Investigate improvements to forecourt at **Farnborough Main Station** to increase bus capacity and improve circulation for pick-up / drop-off trips.

### HIGHGATE LANE JUNCTION

- Reconfigure to improve pedestrian crossing facilities; and
- Provide southbound bus lane on approach to junction.

### HAM & BLACKBIRD GYRATORY

- Review control of junction.

© Crown copyright and database rights 2017 Ordnance Survey [100019180]. Use of this data is subject to terms and conditions. You are granted a non-exclusive, royalty free, revocable licence solely to view the Licensed Data for non-commercial purposes for the period during which HCC makes it available. You are not permitted to copy, sub-license, distribute, sell or otherwise make available the Licensed Data to third parties in any form. Third party rights to enforce the terms of this licence shall be reserved to Ordnance Survey



# Farnborough Growth Package Improvements

## 8. Suggested Options – A325 Farnborough Rd (Clockhouse Roundabout to Boundary Rd)

### BLACKWATER VALLEY GOLD GRID

#### GENERAL MEASURES

- Provide enhanced bus stop facilities along Stagecoach Gold Route 1; and
- Enhance bus priority through technology and / or infrastructure.

#### INVINCIBLE ROAD

- Provide alternative new access from Invincible Road onto A327 Elles Road to relieve congestion (location to be confirmed).

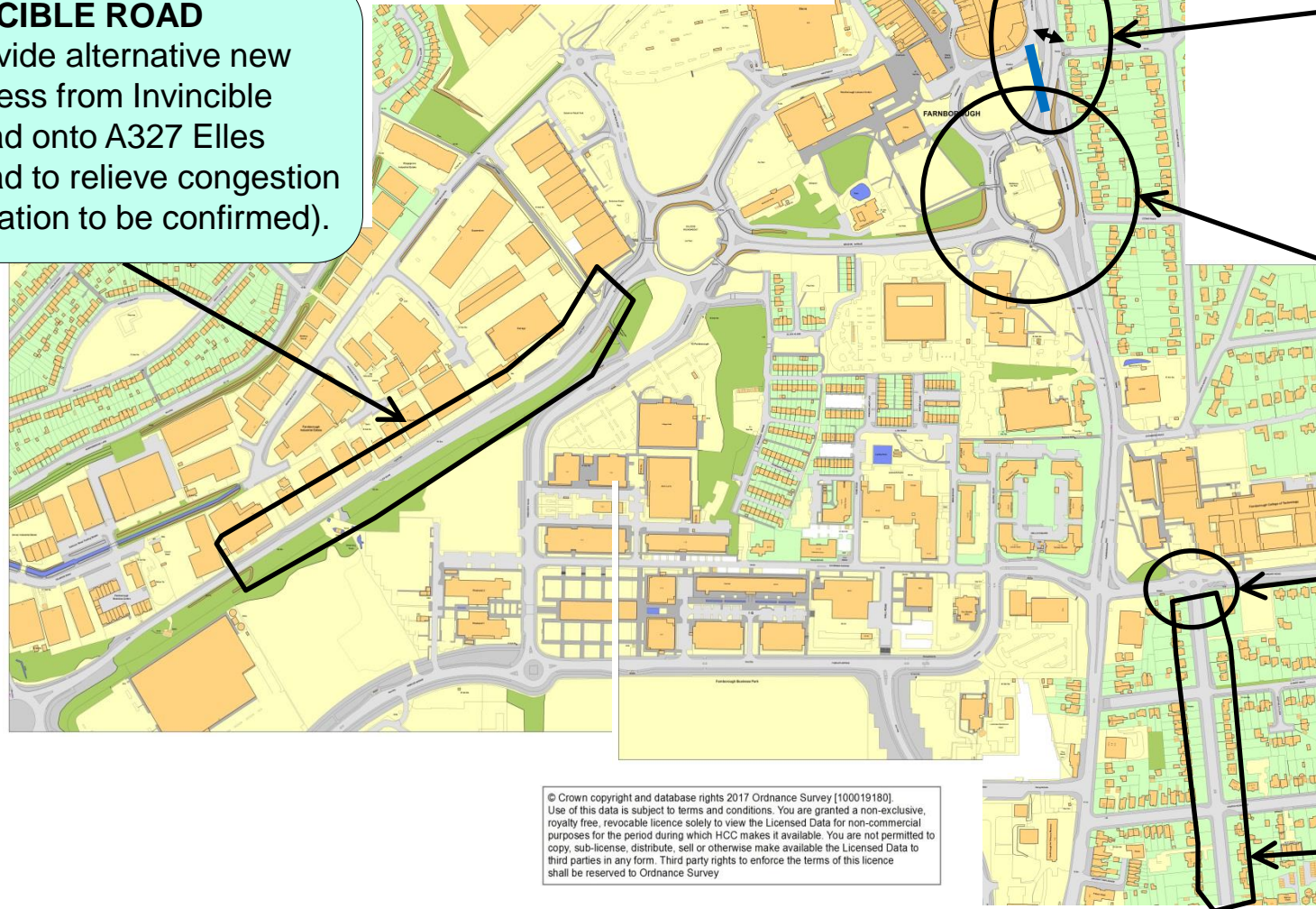

© Crown copyright and database rights 2017 Ordnance Survey [100019180].  
Use of this data is subject to terms and conditions. You are granted a non-exclusive, royalty free, revocable licence solely to view the Licensed Data for non-commercial purposes for the period during which HCC makes it available. You are not permitted to copy, sub-license, distribute, sell or otherwise make available the Licensed Data to third parties in any form. Third party rights to enforce the terms of this licence shall be reserved to Ordnance Survey

#### CLOCKHOUSE ROUNDABOUT

- Investigate traffic signal control of junction to improve pedestrian / cycle crossing facilities; and
- **May** require access restrictions in / out of Salisbury Road

#### KINGSMEAD

- New pedestrian / cycle crossing over A325 from Oak Road;
- New bus only link from A325; and
- Improve bus interchange facilities.

#### PINEHURST ROUNDABOUT

- Signalise roundabout and review overall road layout; and
- Longer term option could see roundabout replaced by signalised T-junction to release land for redevelopment.

#### BOUNDARY ROAD

- Improve northbound cycle connection from Alexandra Road to Boundary Road northern footway.

#### ALEXANDRA ROAD

- Provide consistent cycle lane provision.



# Farnborough Growth Package Improvements

## 9. Suggested Short Term Priorities for Implementation

### PRIORITY LOCATIONS FOR INITIAL IMPLEMENTATION

The following schemes have been identified for implementation in the short term with the available funding.

#### BLACKWATER VALLEY GOLD GRID

- Improvements to increase bus capacity at Farnborough Main Station forecourt;
- Provide enhanced bus stop facilities along Stagecoach Gold Route 1; and
- Enhance bus priority through technology / infrastructure.

#### INVINCIBLE ROAD

- Provide an additional egress from Invincible Road onto the A327 Elles Road to address existing congestion issues.

#### LYNCHFORD ROAD

Undertake improvements in the following priority

- Improve St Alban's Roundabout and increase capacity on section to Peabody Road;
- Widen A3011 Lynchford Road from Morris Road to A331 junction; and
- Widen A3011 Lynchford Road between Queen's Roundabout and St Alban's Roundabout.

Assume section between Peabody Road and Morris Road to be delivered in a later phase due to complexities acquiring third party land.

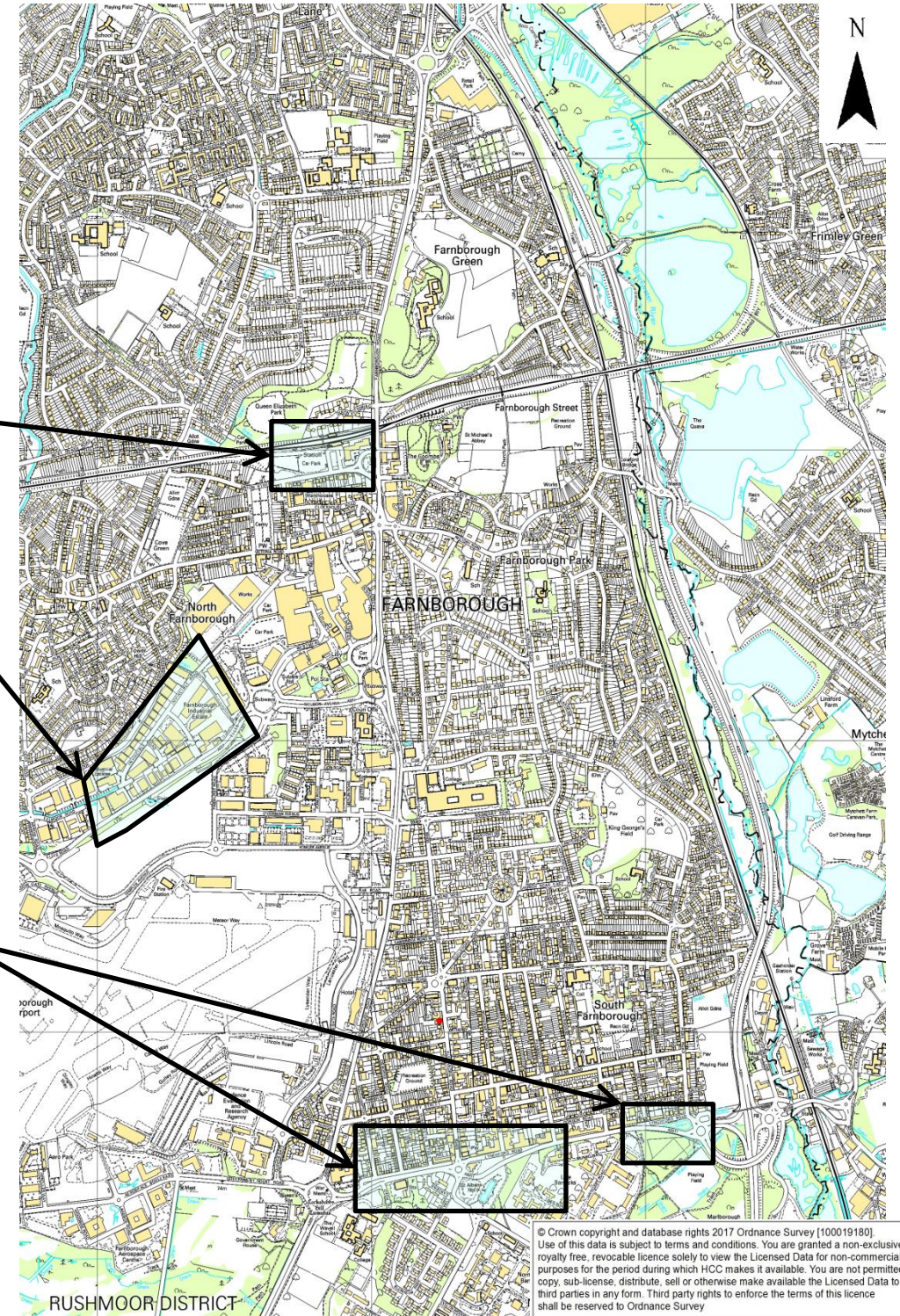



# Farnborough Growth Package Improvements

## 10. Where Next?



### Contact us:

**Strategic Transport  
Hampshire County Council  
The Castle  
Winchester  
Hampshire  
SO23 8UJ**

### Email address:

**major.schemes@hants.gov.uk  
(please type 'Farnborough  
Growth Package' in the subject  
line)**

### Phone:

**0300 555 1388**

## What do you think?

### Your views are important

Your feedback will help identify the preferred way forward and will inform the design process for the scheme. It is intended that a report will be taken to Hampshire County Council's Executive Member for Environment and Transport in March 2018 which will summarise the feedback from this consultation and seeks approval to adopt the overall Farnborough Growth Package and confirm the schemes that should go forward as a priority for implementation in the short term.

Please fill out a paper questionnaire to let us know what you think. Alternatively visit our website [www.hants.gov.uk/transportschemes](http://www.hants.gov.uk/transportschemes) and search for 'Farnborough Growth Package' to leave your comments via the on-line survey.

This exhibition material is also available to download on this website.

**Thank you for visiting the exhibition. The consultation is open for a seven week period from 28 November 2017 to 15 January 2018. The closing date for all responses is 15 January 2018.**